

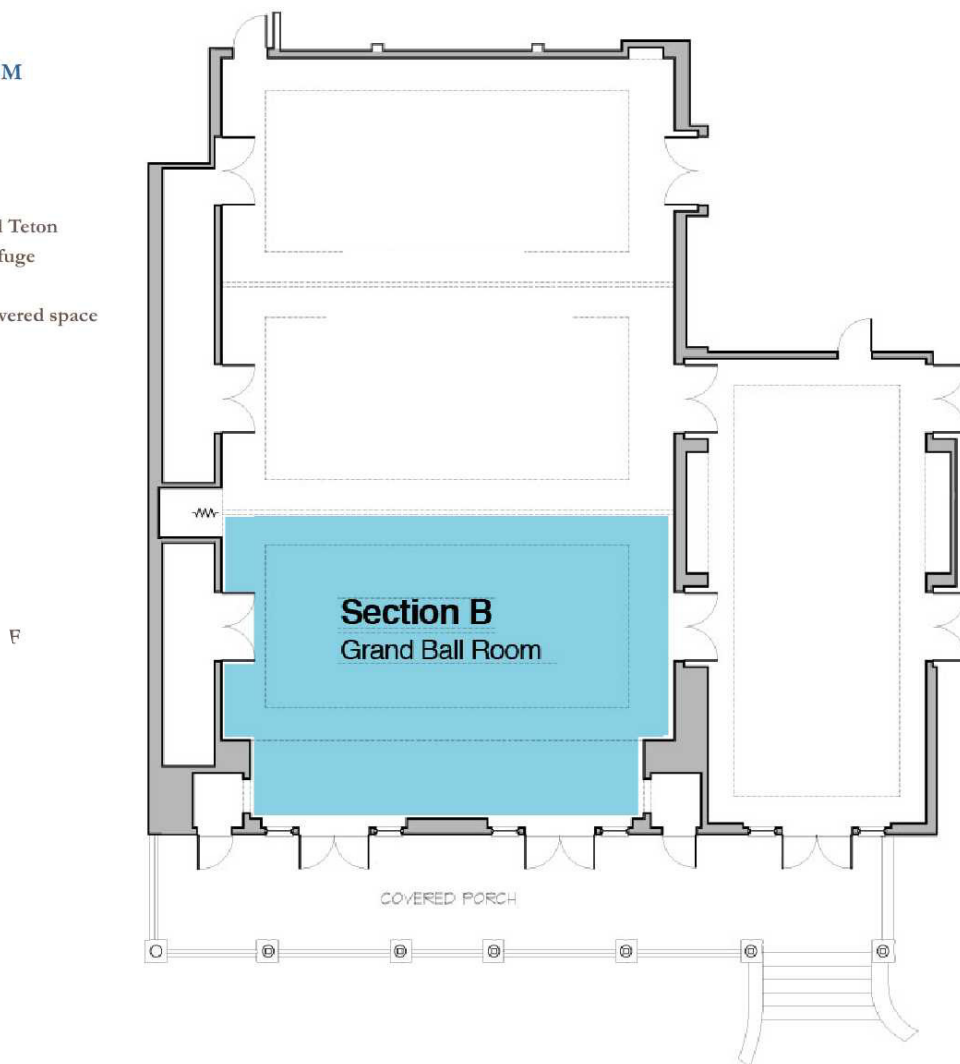

GRAND VIEW BALLROOM

Room (Section B)

- *1,047 square feet
- *13'6" to 16' ceiling height
- *Ballroom windows face toward the Grand Teton Mountain Range and the National Elk Refuge
- *Assembly area is 800 square feet
- *Private balcony is 600 square feet with covered space for receptions and breaks
- *Square footages are approximate.





Event Facility Capacity

	Square Feet	Theater	Class	Banq. Rounds	Banq. Rects.	Conference	U-Shape	Hollow Square	Reception Chairs
Grand View Ballroom	2613	324	192	144	168	30	68	88	345
Grand View Room A	1560	160	96	72	96	30	42	54	190
Grand View Room B	1047	96	60	48	72	30	27	40	130
Cache Creek Room	1812	104	126	112	96	30	58	76	245
Cache Creek A	1168	72	64	64	64	30	32	40	150
Cache Creek B	633	56	32	32	32	30	25	28	90
Board Room	328	18	18	0	0	0	0	0	0

Need more space? [View Event Facility Floorplans at the Snow King Resort Hotel and Conference Center.](#)